

3650 Meeniyam - Promontory Rd, Yanakie

service road

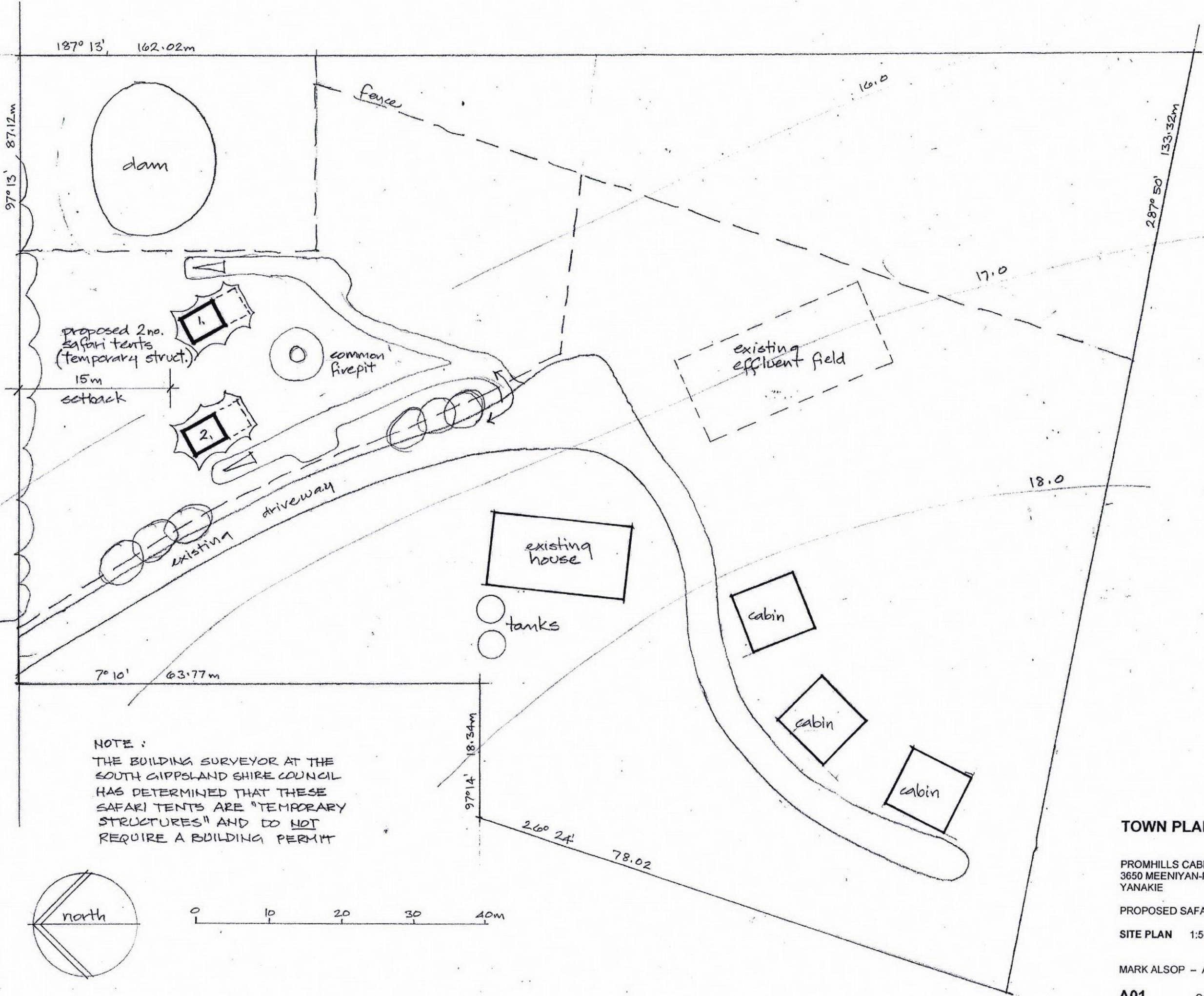

NOTE:
 THE BUILDING SURVEYOR AT THE SOUTH GIPPSLAND SHIRE COUNCIL HAS DETERMINED THAT THESE SAFARI TENTS ARE "TEMPORARY STRUCTURES" AND DO NOT REQUIRE A BUILDING PERMIT

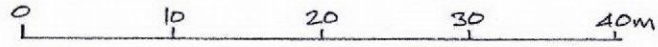
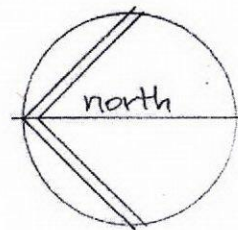

TOWN PLANNING

PROMHILLS CABINS
 3650 MEENIYAN-PROMONTORY RD
 YANAKIE

PROPOSED SAFARI TENTS

SITE PLAN 1:500@ A3

MARK ALSOP - Architect

A01 OCT 2015