

**REGISTER SEARCH STATEMENT (Title Search) Transfer of
Land Act 1958**

Page 1 of 1

VOLUME 11344 FOLIO 680

Security no : 124055616407M

Produced 13/06/2015 05:48 pm

CROWN GRANT

LAND DESCRIPTION

Crown Allotment 2016 Parish of Dowling Forest.

REGISTERED PROPRIETOR

Estate Fee Simple

Sole Proprietor

OLD COLONIST'S ASSOCIATION OF BALLARAT INC of 20 LYDIARD STREET NORTH
BALLARAT VIC 3350

ENCUMBRANCES, CAVEATS AND NOTICES

Any crown grant reservations exceptions conditions limitations and powers noted on the plan or imaged folio set out under DIAGRAM LOCATION below. For details of any other encumbrances see the plan or imaged folio set out under DIAGRAM LOCATION below.

DIAGRAM LOCATION

SEE TP946107S FOR FURTHER DETAILS AND BOUNDARIES

ACTIVITY IN THE LAST 125 DAYS

NIL

DOCUMENT END

TITLE PLAN		EDITION 1	TP 946107S
LOCATION OF LAND PARISH : DOWLING FOREST SECTION : CROWN ALLOTMENT : 2015 AND 2016 MGA94 Co-ordinates (of approx. centre of land in plan) E 748890 ZONE: 54 N 5841300 GDA 94 DEPTH LIMITATION : 15 Metres		NOTATIONS: SUBJECT TO ANY RESERVATIONS, EXCEPTIONS, CONDITIONS AND POWERS NOTED ON SHEET 2 OF THIS PLAN.	
		THIS PLAN HAS BEEN PREPARED BY LAND VICTORIA FOR TITLE DIAGRAM PURPOSES.	Checked by: <i>[Signature]</i> Date: 6/2/2012 Assistant Registrar of Titles

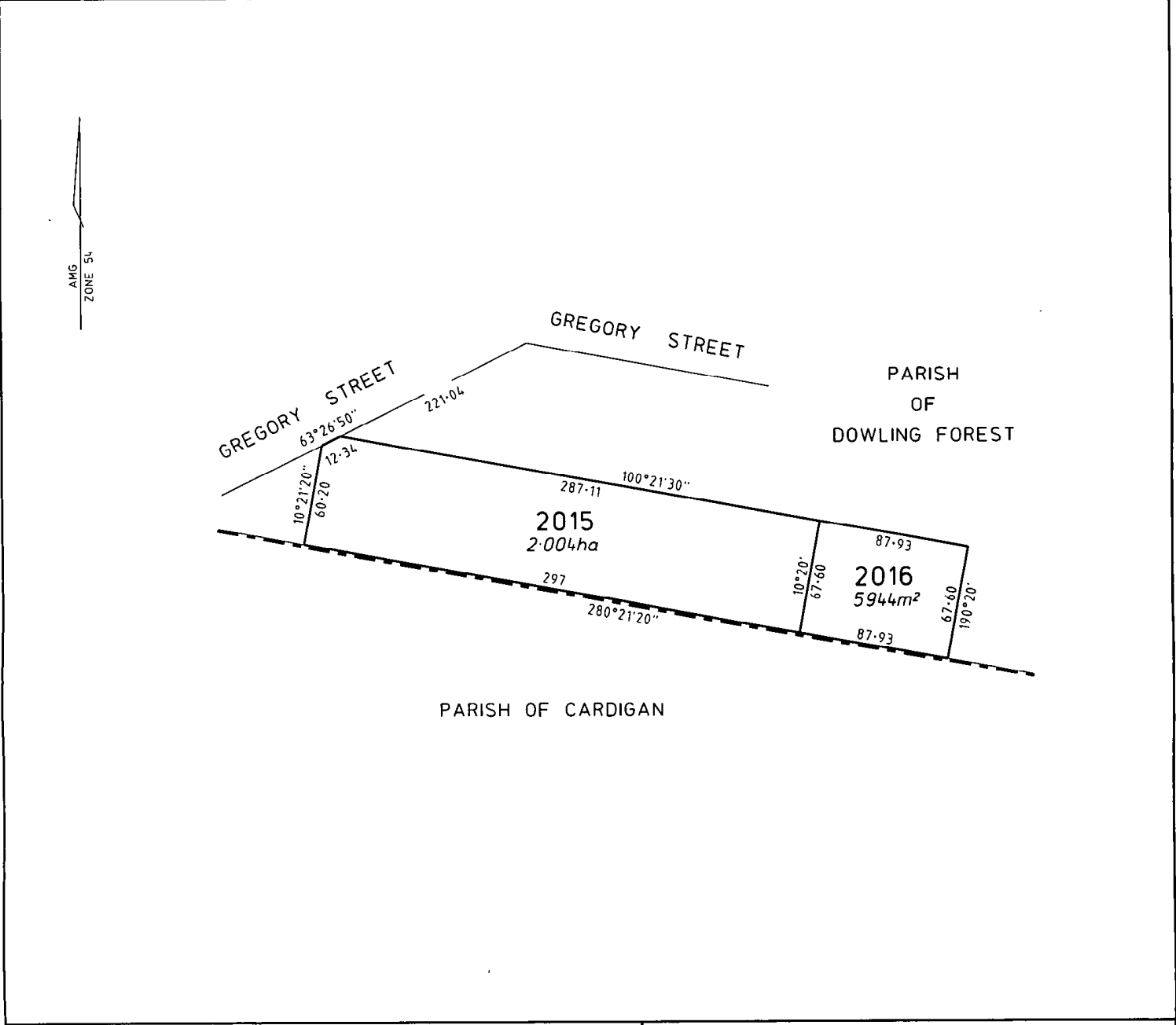

PREPARED FROM: VDP, PARISH PLAN 2542, OP121940 AND PLAN REF 2493 BY R.J.STEEL L.S. IN FILE.		PLAN FOR CROWN GRANT PURPOSES	
		DRAWN: MWP 13/10/2011 CAD FILE: TP946107S.DGN	CHECKED: K.TRAN 31/10/2011
OFFICE OF SURVEYOR-GENERAL VICTORIA DEPARTMENT OF SUSTAINABILITY AND ENVIRONMENT	SCALE 25 0 25 50 75 100 LENGTHS ARE IN METRES		<i>[Signature]</i> SURVEYOR-GENERAL 2. 2. 2012 DATE
	SCALE 1:2500	SHEET SIZE A3	File Ref. F2001/02540 Sheet 1 of 2 Sheets

TITLE PLAN

TP 946107S

RESERVATIONS EXCEPTIONS CONDITIONS AND POWERS

The reservation to the Crown of:

- any minerals as defined in the *Mineral Resources (Sustainable Development) Act 1990* and petroleum as defined in the *Petroleum Act 1998* (the "reserved minerals");
- rights of access to any part of the land to search and obtain the reserved minerals; and
- rights of access to any part of the land for pipe-lines, works and other purposes necessary to obtain and convey the reserved minerals on and from the land;

The right to resume the said land for mining purposes under Section 205 of the *Land Act 1958*; and

The right of a licensee under the *Mineral Resources (Sustainable Development) Act 1990* or any corresponding previous enactment, to enter land and do work, within the meaning of that Act, and to erect and occupy mining plant or machinery on the land, in the same manner and under the same conditions and provisions as such licensee currently has on Crown land, provided compensation is paid under Part 8 of that Act for surface damage to the lands.

The condition that the grantees and its successors in title shall take the said land notwithstanding the impediment that no legal road access thereto has been provided or implied by these presents to the above mentioned allotment 2016 and the grantees and its successors in title agree to indemnify Us Our heirs and successors against the expenses of acquiring or providing an easement of way to the land hereby granted or any part thereof.

As to Crown Allotment 2016 in this plan -

The condition that the land shall only be used for the purpose of Welfare Housing of a Non-Commercial Basis.

FINAL SEARCH STATEMENT

Land Victoria

Page 1 of 1

Security No : 124055616409K

Volume 11344 Folio 680

Produced 13/06/2015 05:50 PM

ACTIVITY IN THE LAST 125 DAYS

NIL

STATEMENT END